

**NOTICE OF STUDY SESSION**  
**Fence Options (Annex /Trinity Renovations)**

CITY HALL, Fifth Floor  
6801 Delmar Blvd.  
University City, Missouri 63130  
**Monday, July 11, 2022**  
**5:30 p.m.**

**AGENDA**

1. Meeting called to order
2. Changes to Regular Agenda
3. Fence Options - Annex and Trinity Building Renovations
4. Adjournment

Citizen may also observe the Meeting via Live Stream on YouTube:  
[https://www.youtube.com/channel/UCyN1EJ\\_-Q22918E9EZimWoQ](https://www.youtube.com/channel/UCyN1EJ_-Q22918E9EZimWoQ)

Posted this 8<sup>th</sup> day of July, 2022.

LaRette Reese  
City Clerk



CHIEF HAMPTON'S  
UPDATE ON CPTED  
SUGGESTED LAW  
ENFORCEMENT SITE

UCPD 2022

## Key Issues with Soft Targets for L. E. when Dealing with Criminals

▶ In 2019, 2,231 inmates escaped from state or federal prisons in the United States. This is a decrease from the previous year, when 2,351 prisoners escaped from facilities across the United States. Oct 27, 2021

▶ Unlike in movies, security experts say, inmates tend to wait until they are outside of prison walls to make a run for it. Kevin Tamez, an inmate advocacy consultant, says that any time an inmate leaves a correctional facility, there is a heightened risk of escape. "There are ways of minimizing it, but there's never a way to prevent it," he says.

## L.E. Personnel are Ambushed More Frequently than Imagined

- ▶ MUSKOGEE, Okla. — The Muskogee Police Department announced it had implemented a new level of security for its officers.
- ▶ Muskogee police said it built fencing in the police department's back parking lot to provide the added security they were seeking.
- ▶ The safety measure comes after the department experienced a deadly ambush in December of 2019.
- ▶ The department said Fayetteville officer Stephen Carr was ambushed and executed sitting inside his patrol car. Officials said Officer Carr was



## Sergeant Michael R. King

*University City Police Department, Missouri*

End of Watch: Friday, October 31, 2008

[ADD TO MY HEROES](#)

### MICHAEL R. KING

Sergeant Michael King was shot and killed from ambush as he sat in his patrol car at the intersection of Leland Avenue and Delmar Boulevard. A known criminal approached his vehicle on foot and opened fire without warning, fatally wounding Sergeant King.

The suspect fled the scene but was arrested five days later following a

### BIO

**Age:** 50

**Tour:** 25 years

**Badge:** 17

### INCIDENT DETAILS

**Cause:** Gunfire



Below is a recent (Feb. 2022) ranking amongst cities with 100,000 population or more: *Forbes.com*

## **10 Most Dangerous Cities in the US (#1 is the highest chances of crime)** 297 cities whose population is 100,000 or more

1. St. Louis, Missouri
2. Jackson, Mississippi
3. Detroit, Michigan
4. New Orleans, Louisiana
5. Baltimore, Maryland
6. Memphis, Tennessee
7. Cleveland, Ohio
8. Baton Rouge, Louisiana
9. Kansas City, Missouri
10. Shreveport, Louisiana

My concern is always safety.



## UCPD Needs for Combatting Crime Trends

Fox News examined crime data from Baltimore, Chicago, Los Angeles, New York City, Philadelphia, Seattle and Washington, D.C., and found violent crimes have increased anywhere from nearly 5% to up to 40% compared to the same time frame in 2021. Violent crimes are typically defined as reports of rape, sexual assault, robbery, assault, and murder.

Across the country this year following 2020's already skyrocketing national murder spike that bled into the following year.





## Recent Examples of L.E. Infrastructures Under Siege

Minneapolis & Los Angeles Police Departments

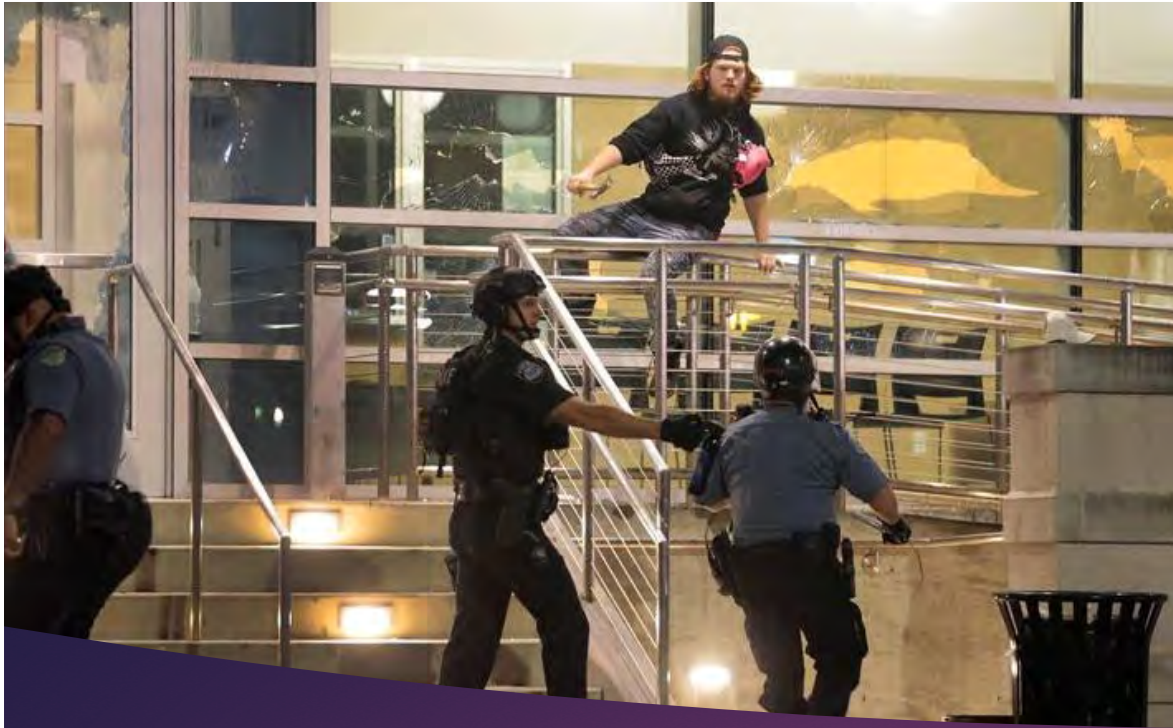

## Recent Examples

- ▶ Ferguson 2020









COUNTY POLICE

KENDALL COUNTY ILLINOIS  
A128

www.kendallcountyil.gov



# Aerial Views of Employee Parking Personal Vehicles

Lot Close to UCPD Building



Lot Close to old PD entrance



Lot on west side of City Hall









**BELLEVILLE  
POLICE**

**BELLEVILLE  
POLICE**

## Dept. of Defense Best Practices

### 1-3 SECURITY FENCES AND GATES:

Security fences and gates are installed and used primarily to define the perimeter of protected areas, such as restricted areas, controlled areas, entry control/access control points, installation perimeters, and to provide a physical and psychological deterrent to entry and preventing unauthorized personnel from entering a protected area.

UFC 4-022-02  
1 October 2013

Figure 1-2 Diagram of Physical Security System Functions



## CPTED stands for Crime Prevention Through Environmental Design

CPTED focuses on the physical design of your neighborhood - fencing, lighting, plantings - to identify areas or elements that may have the potential to attract crime.

It focuses in the areas of Natural Surveillance, Natural Access Control and Territoriality/Defensible Space.

**CPTED** promotes and prioritizes increased visibility in and around a property to deter burglars and thieves, who frequently target areas and residences with low visibility. This can be counteracted in the following ways: (UCPD have addressed all these below suggested best practices.

**Lighting** - street lights should be well spaced and in working order, alleys and parking areas should also be lit. Lighting should also reflect the intended hours of operation, i.e., lighting of playfields or structures in local parks may encourage after-hour criminal activities. Motion-sensing lights perform the double duty of providing light when needed and letting trespassers know that "they have been seen."

**Landscaping** - Generally uniformly shaped sites are safer than irregularly shaped sites because there are fewer hiding places. Plants should follow the 3-8 rule of thumb; hedges no higher than 3 feet, and tree canopies starting no lower than 8 feet. This is especially important around entryways and windows.

**Fencing** - Fences should allow people to see in. Even if the fences are built for privacy, they should be of a design that is not too tall and has some visibility.

**Windows** - Windows that look out on streets and alleys are good natural surveillance, especially bay windows. These should not be blocked. Retirees, stay at home parents, and people working from home offices can provide good surveillance for the neighborhood during the day.

# CPTED stands for Crime Prevention Through Environmental Design

## . Natural Access Control

Access Control refers to homes, businesses, parks and other public areas having distinct and legitimate points for entry and exits. However, this should also be balanced to avoid "user entrapment," or not allowing for easy escape or police response to an area.

**Generally, crime perpetrators will avoid areas that only allow them with one way to enter & exit, also that have high visibility and/or have a high volume of user traffic.**

- Park designs with open, uninhibited access and a defined entry point. A good example is a park with transparent fencing around the perimeter, and one large opening in the gate for entry. Putting vendors or shared public facilities near this entrance creates more traffic and more surveillance.
- River rocks used in landscaping can be thrown at the building or personnel
- Climbable trees near a secured fence line can enable an intruder to gain access to secured areas
- Signs identifying reserved parking spaces can reveal the identities of personnel in the building to the public

A Person's Will to Complete a Task Can Often Outmatch Preparation  
(Kirkwood 2008 aftermath & Univ. City current)

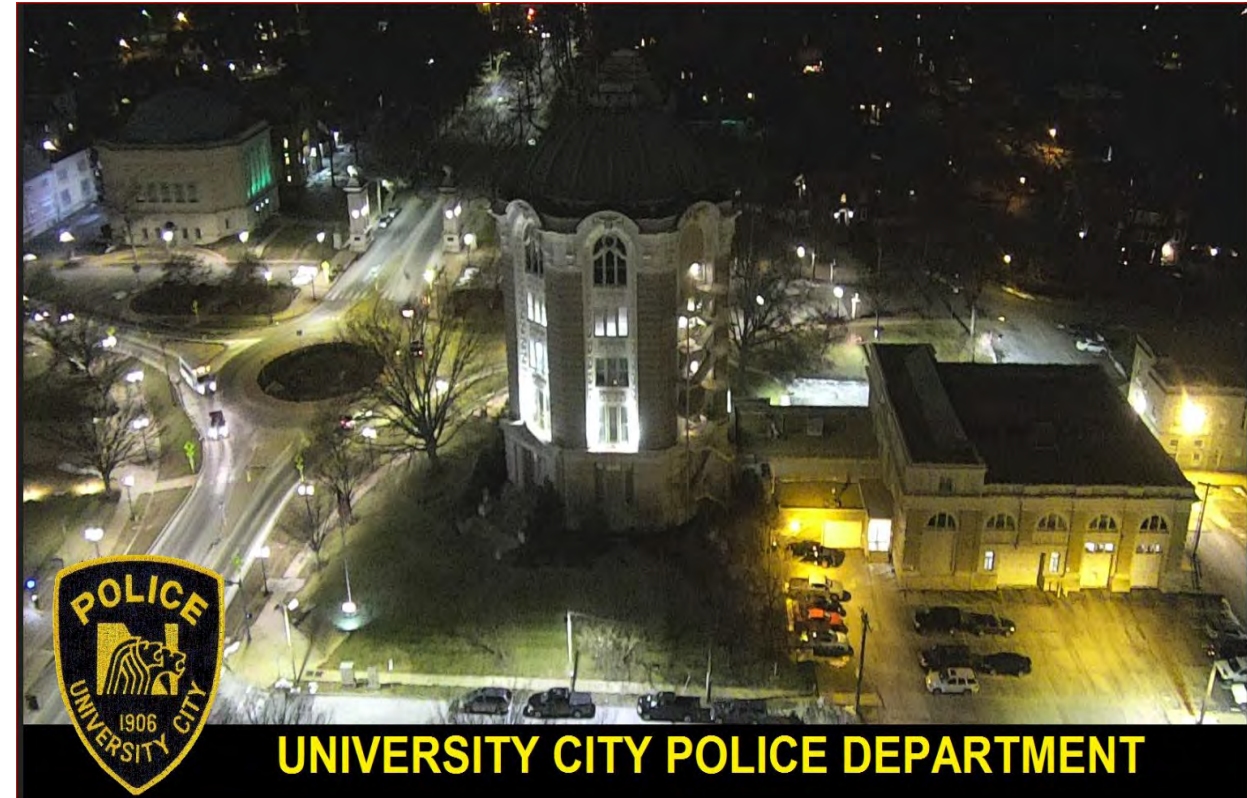

**UNIVERSITY CITY POLICE DEPARTMENT**



ANY  
QUESTIONS

**U City Annex + Trinity Renovation**  
City Council Study Session

July 11, 2021

Trinity  
Services



# Agenda

1. 6.27.22 Meeting Recap
2. Alternate Fence Option
3. Neighborhood Access
4. Alternate Perimeter Option
5. Pedestrian Circulation & Walking Distances
6. Next Steps

Historic Preservation Committee Review

# Site Design 9.23.21 Meeting Review

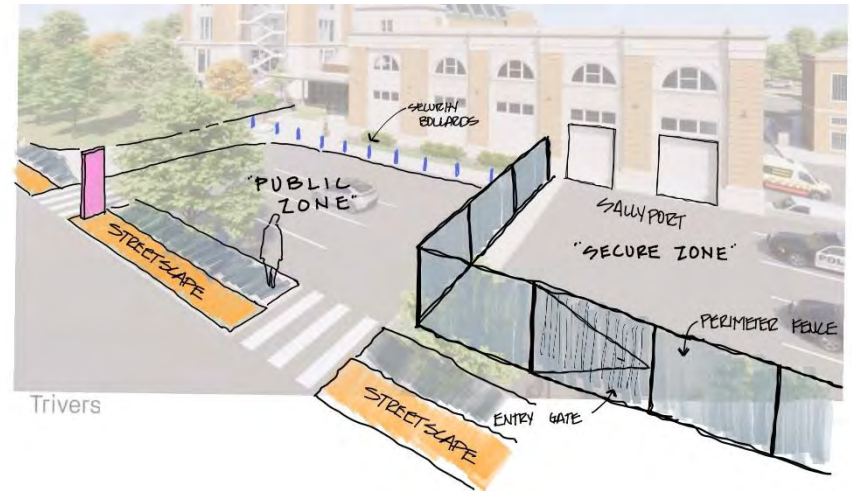
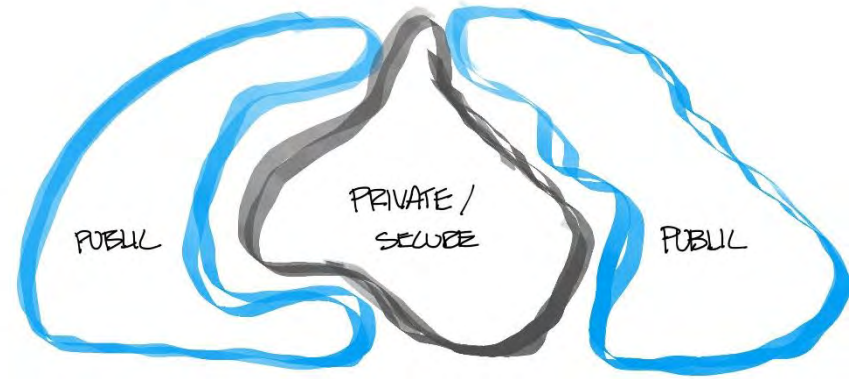
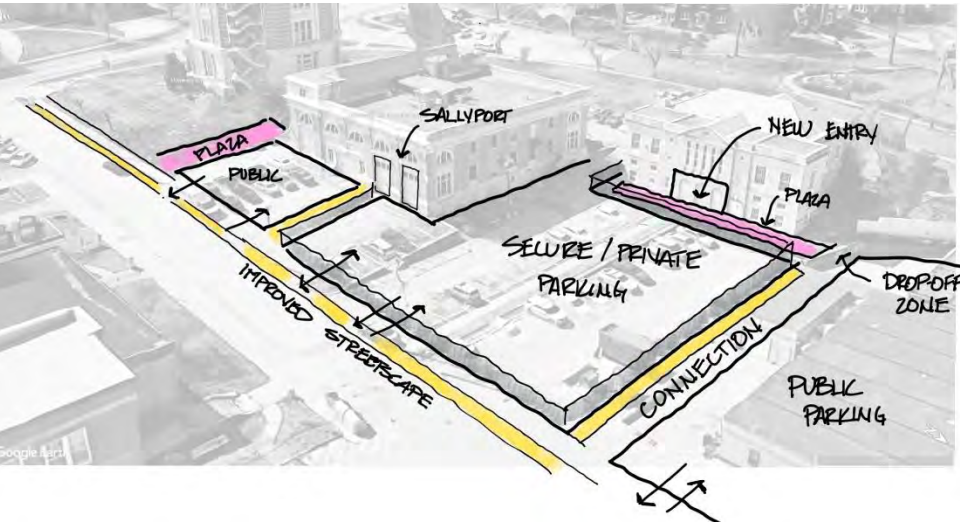

# Site Design – Overall Site



# Site Design – Security 6.27.22 Council Meeting

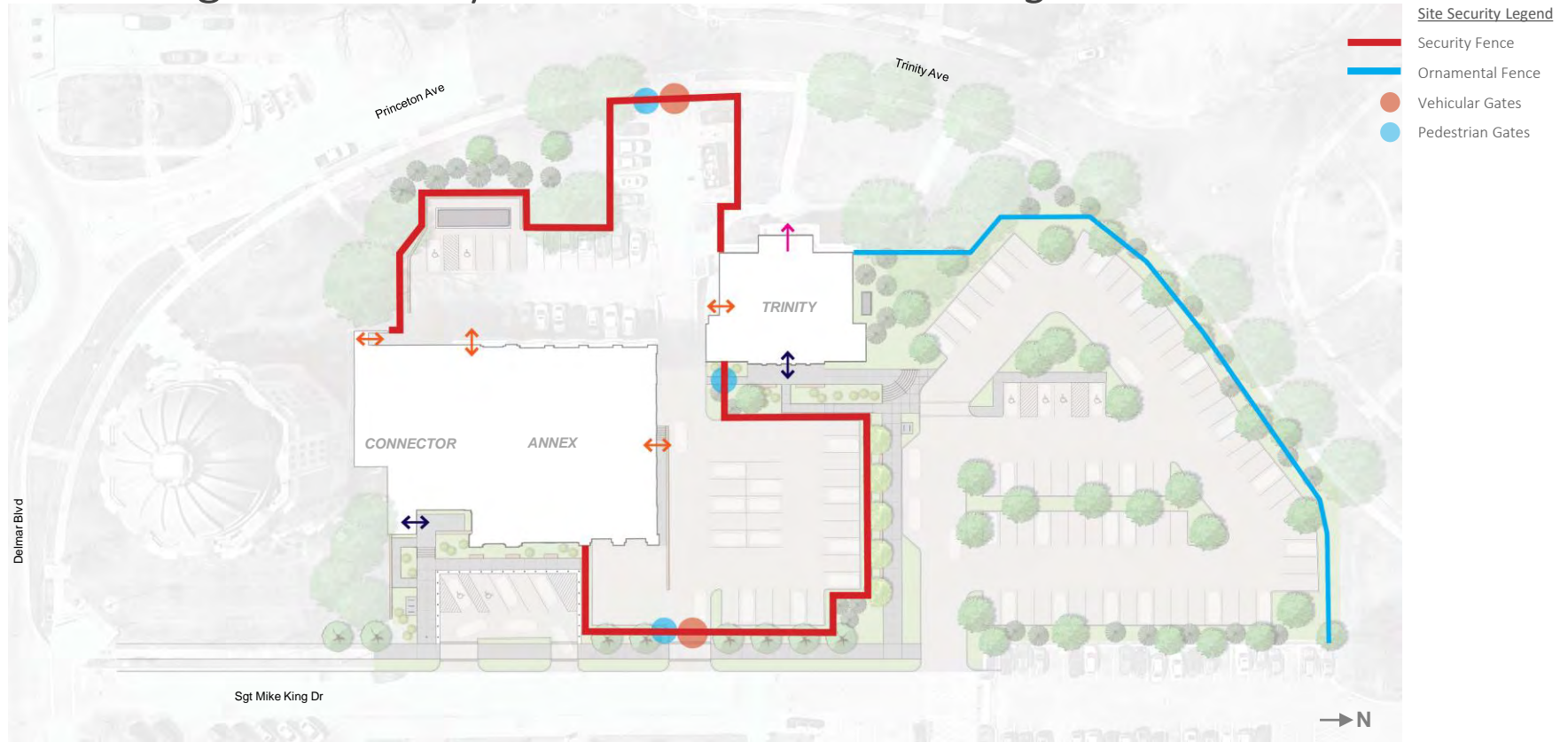

# Site Design – Security 6.27.22 Council Meeting



Security Fence 8' tall, anti-climb



Vehicular Gate

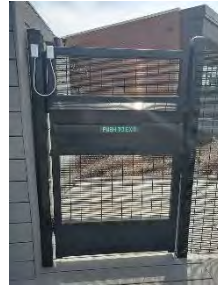

Pedestrian Gate



Ornamental Fence (existing)

To Be Removed

To Remain

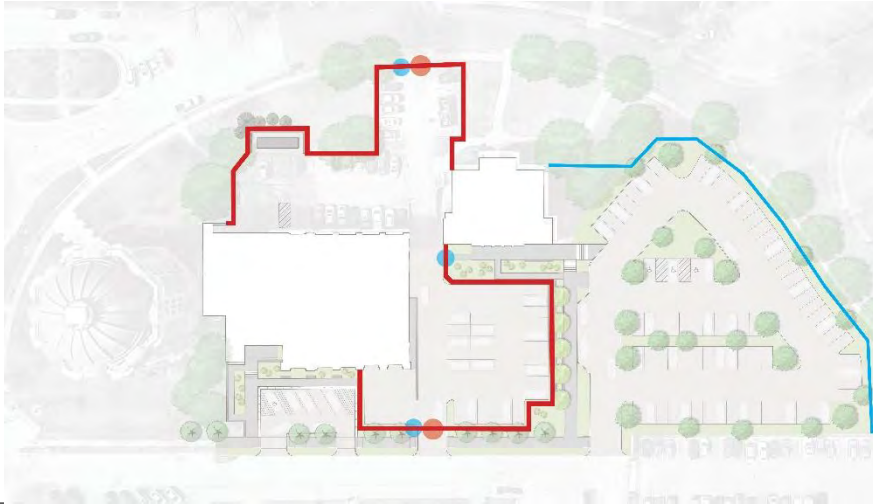

### Site Security Legend

- Security Fence
- Ornamental Fence
- Vehicular Gates
- Pedestrian Gates

# Site Design – Fencing 6.27.22 Council Meeting



Existing ornamental fence at the Lewis Collaborative



Existing ornamental fence at the Lewis Collaborative



View of existing ornamental fence and landscape



Existing pedestrian gate with access to Harvard Ave

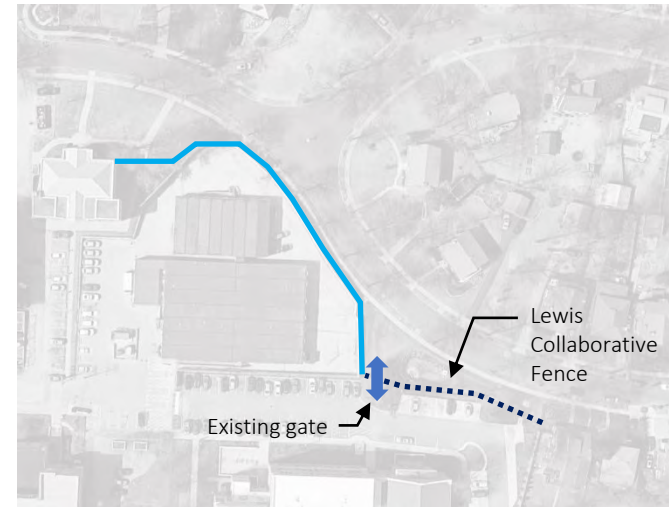

# Site Design – Parking 6.27.22 Council Meeting

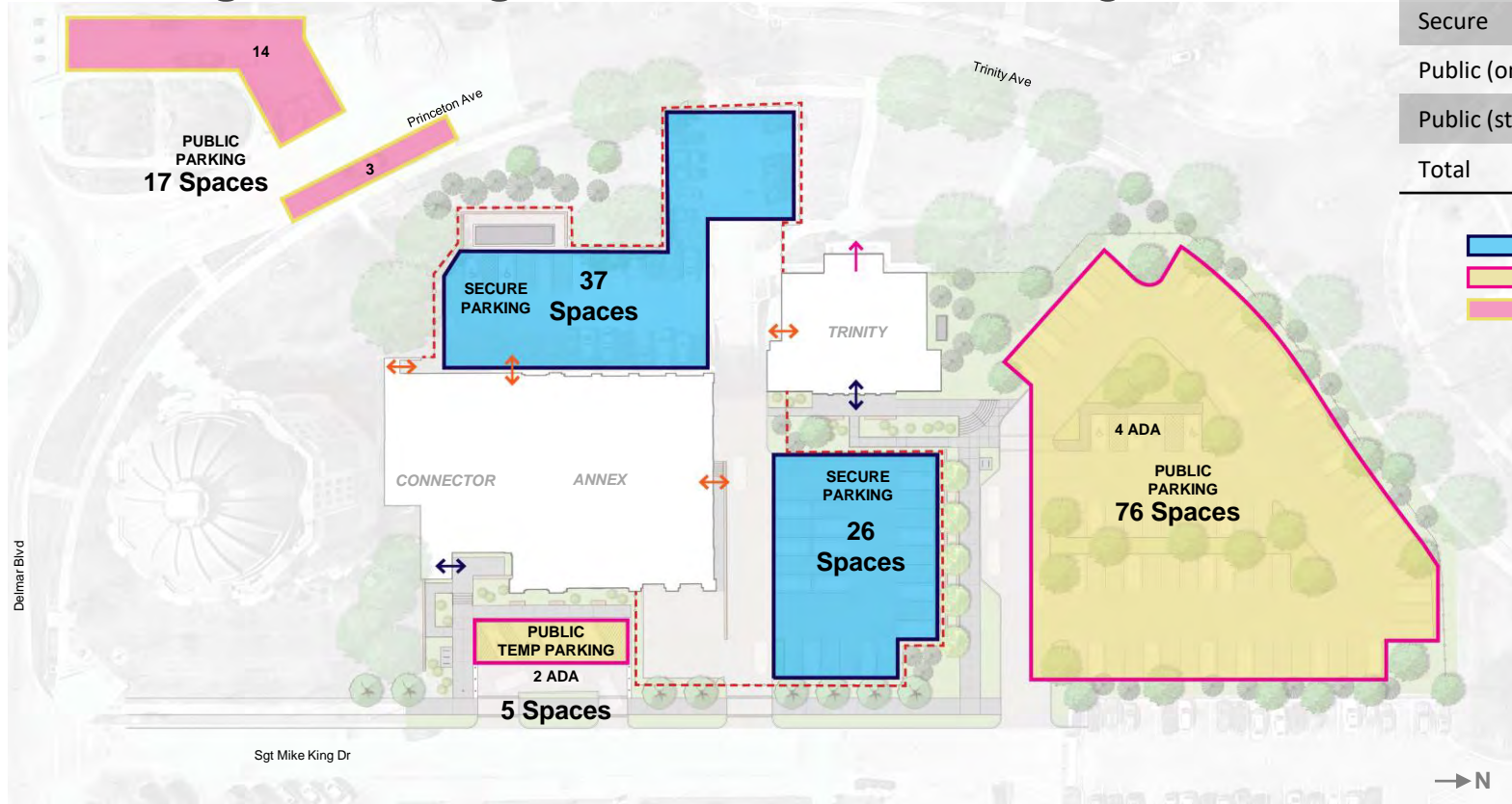

Provided	
Secure	63
Public (on-site)	81
Public (street)	17
<b>Total</b>	<b>161</b>

Parking Legend

<span style="color: blue;">█</span>	Secure Parking
<span style="color: pink;">█</span>	Public Parking (on-site)
<span style="color: yellow;">█</span>	Public Parking (street parking)

# Site Design – Security *Alternate Fence Type*



Security Fence 8' tall

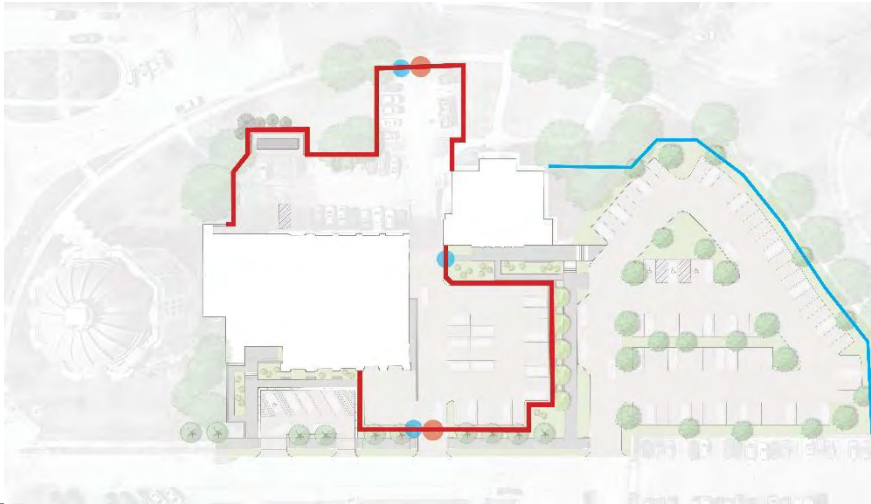
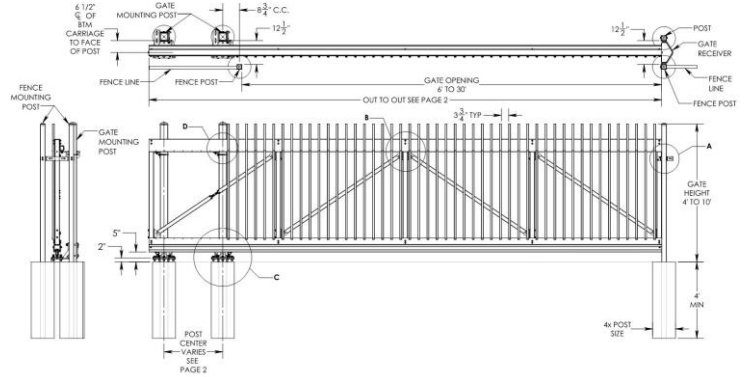

## Site Security Legend

- Security Fence
- Ornamental Fence
- Vehicular Gates
- Pedestrian Gates

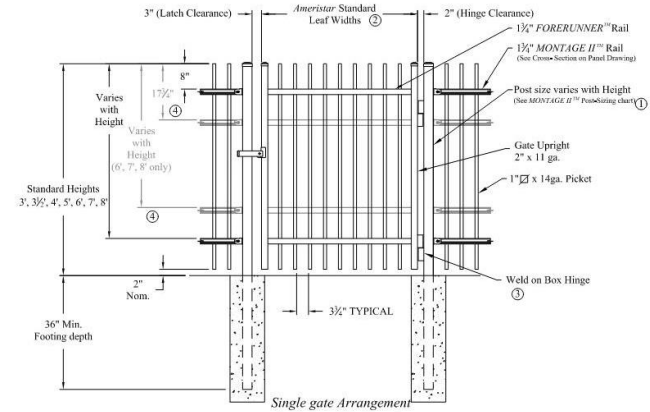



# Site Design – Security *Neighborhood Pedestrian Access*

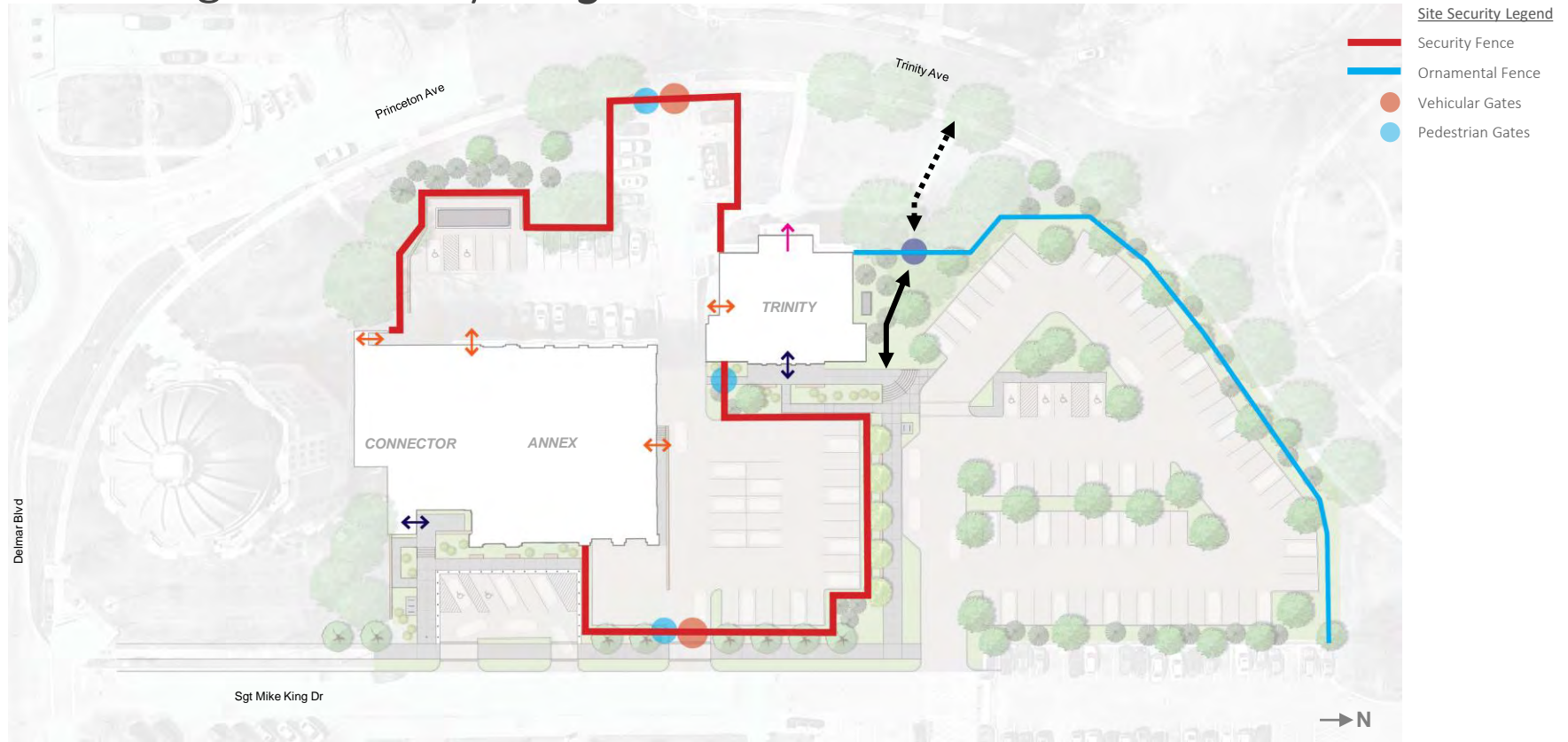

# Site Design – Security *Alternate Perimeter*

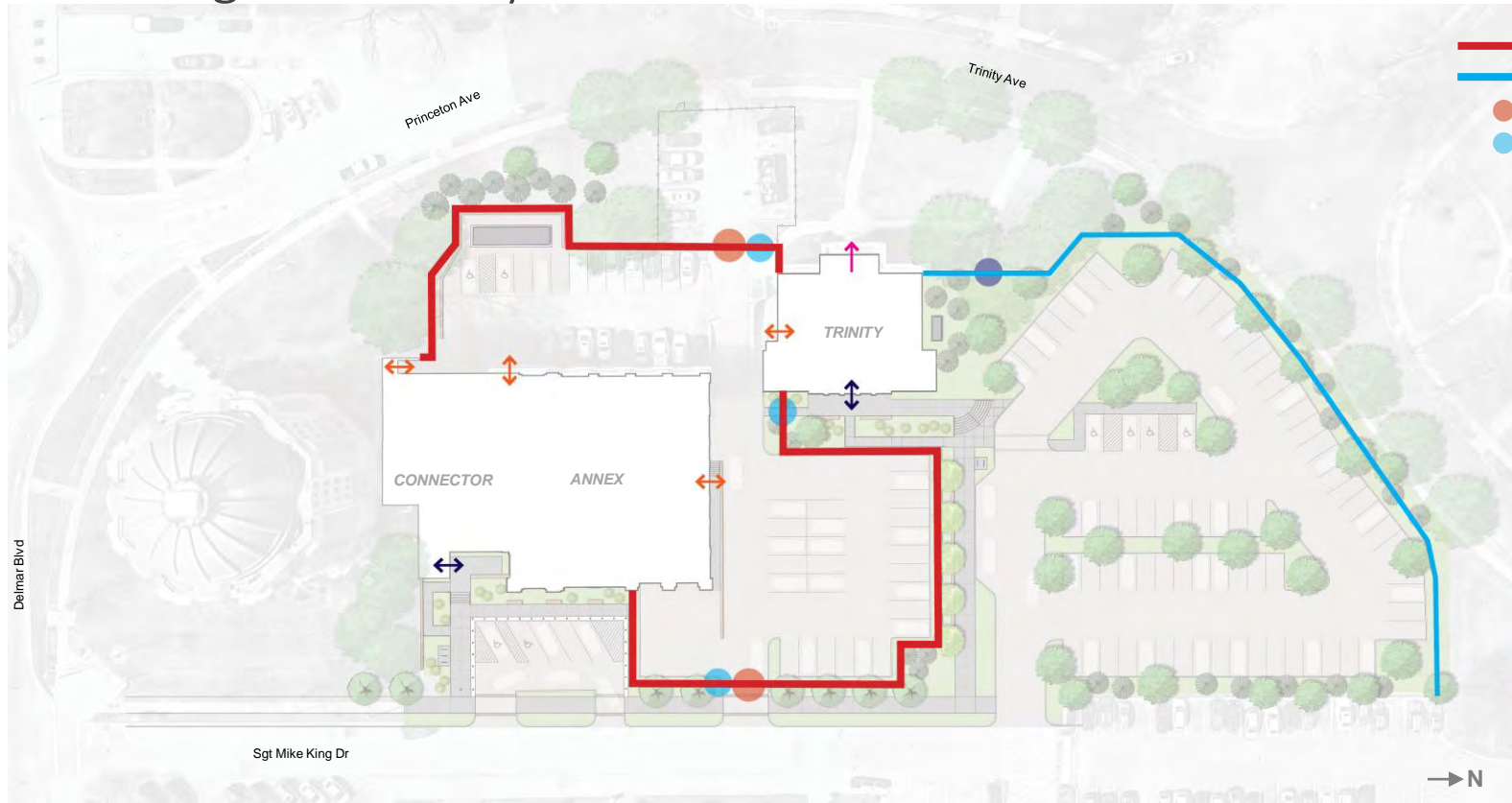

# Site Design – Parking with *Alternate Perimeter*

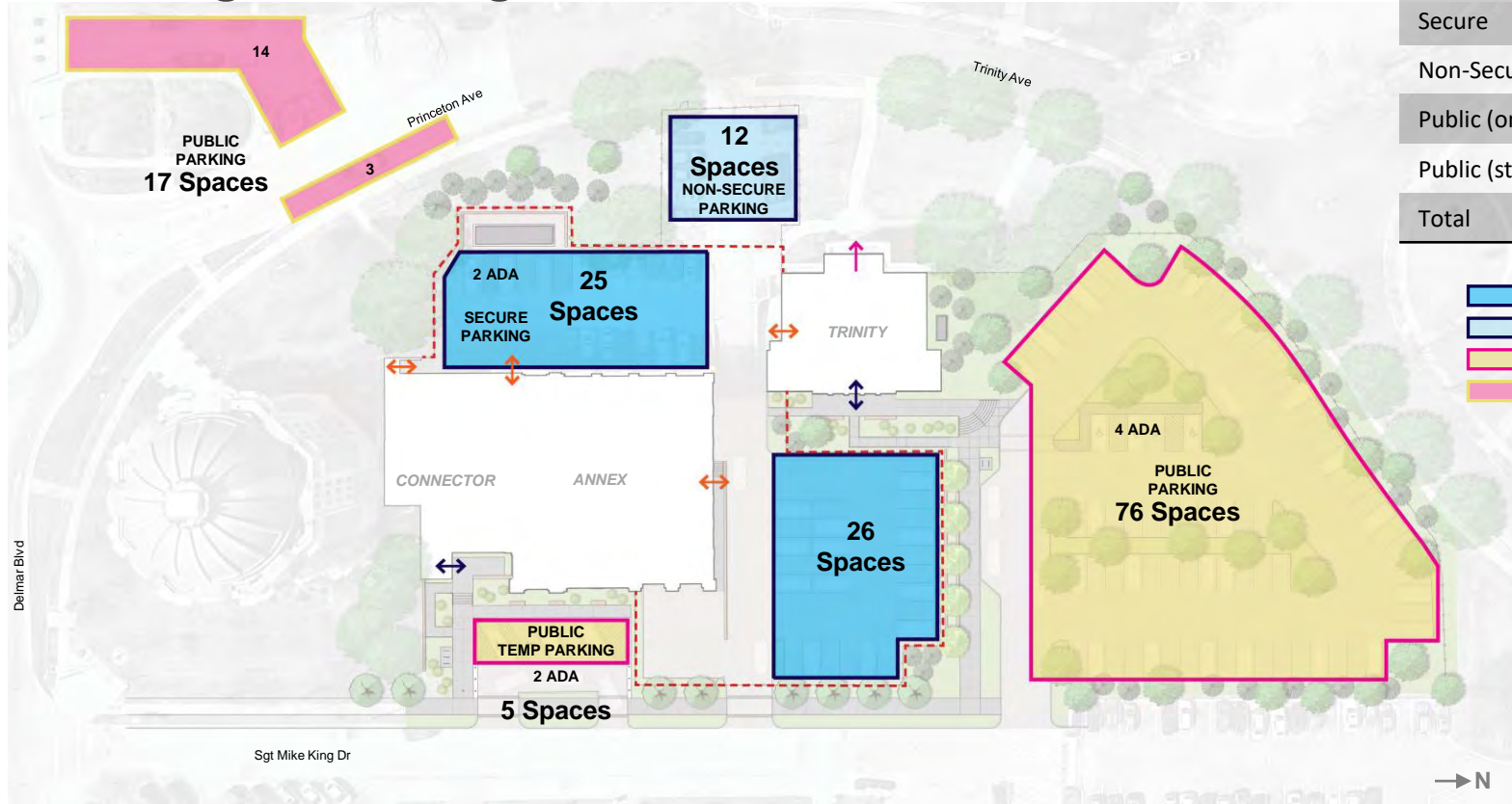

	Provided
Secure	51
Non-Secured	12
Public (on-site)	81
Public (street)	17
<b>Total</b>	<b>161</b>

### Parking Legend

- Secure Staff Parking
- Non-Secure Staff
- Public Parking (on-site)
- Public Parking (street parking)

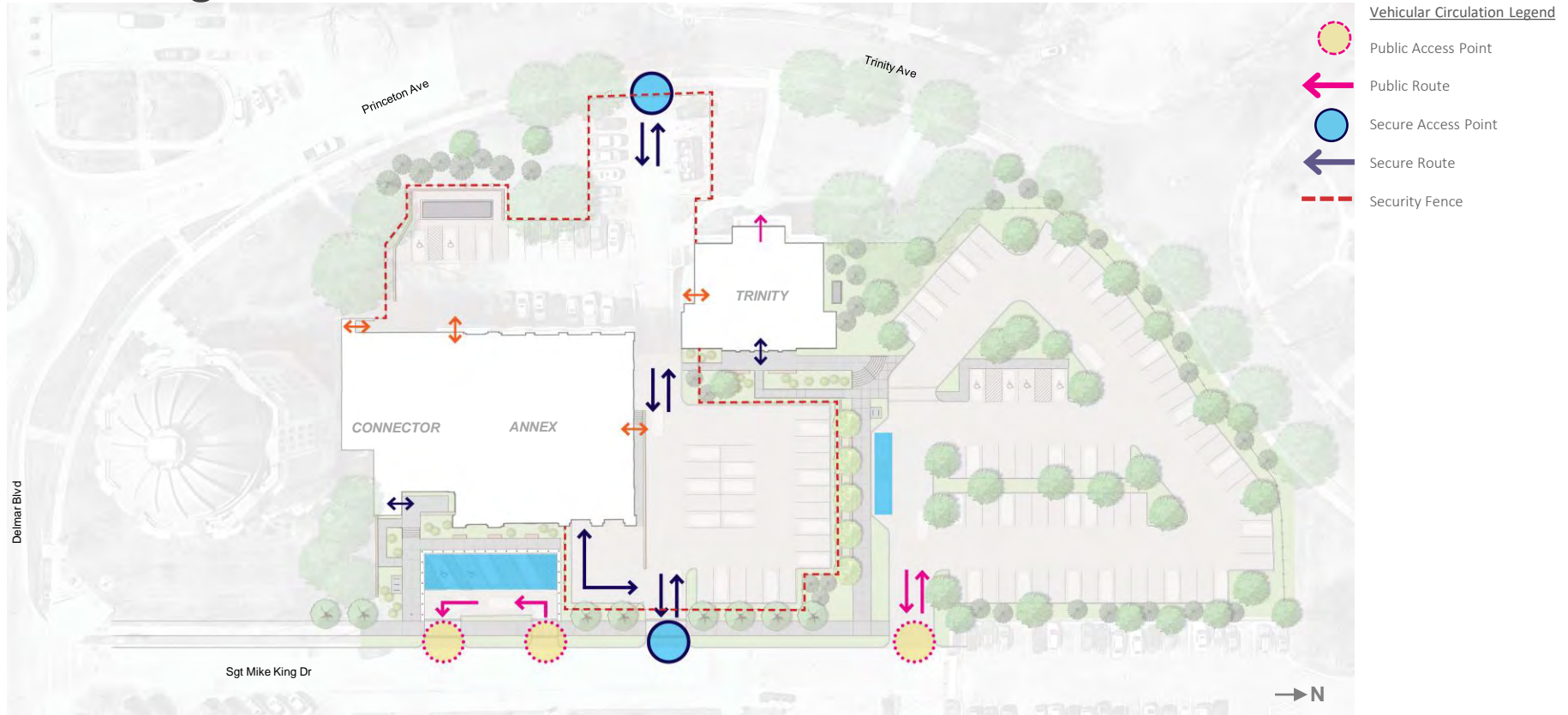

# Site Design – Vehicular Circulation

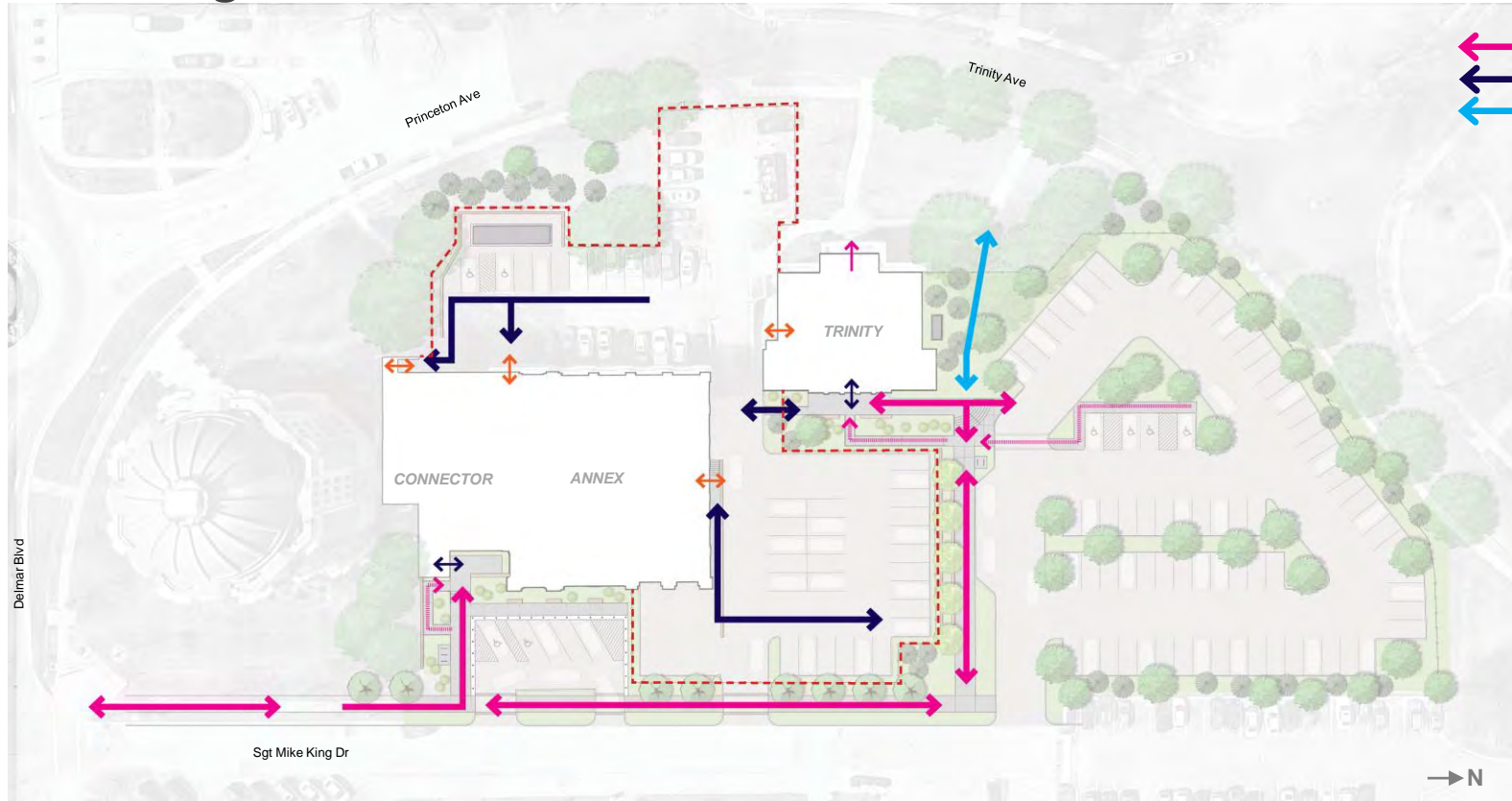

# Site Design – Pedestrian Circulation



## Pedestrian Circulation Legend

-  Public Route
-  Secure Route
-  Neighborhood Access

# Site Design – Walking Distances

