

INTRODUCED BY: Councilmember Jeff Hales

DATE: September 12, 2022

**BILL NO. 9479**

**ORDINANCE NO. 7196**

**AN ORDINANCE VACATING AND SURRENDERING THE RIGHT-OF-WAY OF  
ELMORE COURT.**

WHEREAS, Elmore Court is a public street located in St. Patrick Courts, a subdivision within the City of University City, in St. Louis County, Missouri and recorded in Plat Book 48 Page 33 of the St. Louis County Recorder of Deeds in Clayton, Missouri; and

WHEREAS, due notice of a public hearing on the vacation of said public street to be held by the City Council of City of University City Council on September 27, 2022 at 6:30 p.m., was duly published in the St. Louis Countian, a newspaper of general circulation within said City, on September 11, 2022; and

WHEREAS, said public hearing was held at the time and place specified in said notice, and all comments concerning said vacation were duly heard and considered by the City Council.

NOW, THEREFORE, BE IT ORDAINED BY THE COUNCIL OF THE CITY OF UNIVERSITY CITY, MISSOURI, AS FOLLOWS:

Section 1. The right-of-way of Elmore Court in the City of University City in St. Louis County, Missouri, and all of the City of University City's rights, title and interest therein is hereby vacated, surrendered and quitclaimed, but reserving all public utility easements, if any; said property is more specifically described as follows:

ALL OF ELMORE COURT, 50 FEET WIDE, AS ESTABLISHED BY ST. PATRICK COURTS, A SUBDIVISION ACCORDING TO THE PLAT THEREOF AS RECORDED IN PLAT BOOK 48, PAGE 33 OF THE ST. LOUIS COUNTY RECORDS, LOCATED IN TOWNSHIP 45 NORTH, RANGE 6 EAST OF THE FIFTH PRINCIPAL MERIDIAN, CITY OF UNIVERSITY CITY, ST. LOUIS COUNTY, MISSOURI BEING MORE PARTICULARLY DESCRIBED AS FOLLOWS

BEGINNING AT THE EASTERNMOST CORNER OF LOT 1, BLOCK 1 OF THE ABOVE SAID ST. PATRICK COURTS, SAID POINT ALSO BEING LOCATED ON THE WEST LINE OF WOODSON ROAD, VARIABLE WIDTH, SAID POINT ALSO BEING THE BEGINNING OF A CURVE TO THE RIGHT HAVING A RADIUS OF 25.00 FEET; THENCE ALONG THE SOUTHERN RIGHT-OF-WAY LINE OF SAID ELMORE COURT THE FOLLOWING COURSES AND DISTANCES: ALONG SAID CURVE WITH AN ARC LENGTH OF 39.28 AND A CHORD WHICH BEARS NORTH 44 DEGREES 45 MINUTES 32 SECONDS WEST, 35.28 FEET TO A POINT OF TANGENCY; NORTH 89 DEGREES 46 MINUTES 03 SECONDS WEST, 269.81 FEET TO THE BEGINNING OF A CURVE TO THE LEFT HAVING A RADIUS OF 50.00 FEET, AN ARC LENGTH OF 36.14 FEET AND A CHORD WHICH BEARS SOUTH 69 DEGREES 31 MINUTES 39 SECONDS WEST, 35.36 FEET TO A POINT OF REVERSE CURVATURE TO THE RIGHT HAVING A RADIUS OF 50.00 FEET, AN ARC LENGTH OF 229.35 FEET AND A CHORD WHICH BEARS NORTH 00 DEGREES 13 MINUTES 37 SECONDS EAST, 75.00 FEET TO A POINT OF REVERSE CURVATURE TO THE LEFT HAVING A RADIUS OF 50.00 FEET, SAID POINT ALSO BEING LOCATED ON THE NORTHERN RIGHT-OF-WAY LINE OF ELMORE COURT; THENCE ALONG SAID RIGHT-OF-WAY LINE THE FOLLOWING COURSES AND DISTANCES: ALONG SAID CURVE WITH AN ARC LENGTH OF 36.14 FEET

AND A CHORD WHICH BEARS SOUTH 69 DEGREES 03 MINUTES 46 SECONDS EAST, 36.36 FEET TO A POINT OF TANGENCY; SOUTH 89 DEGREES 46 MINUTES 03 SECONDS EAST, 269.84 FEET TO A POINT OF CURVATURE TO THE LEFT HAVING A RADIUS OF 25.00 AN ARC LENGTH OF 39.26 FEET AND A CHORD WHICH BEARS NORTH 45 DEGREES 14 MINUTES 28 SECONDS EAST, 35.35 FEET ITS INTERSECTION WITH THE WEST RIGHT-OF-WAY LINE OF ABOVE SAID WOODSON ROAD; THENCE CROSSING ELMORE COURT, SOUTH 00 DEGREES 14 MINUTES 59 SECONDS WEST, 100.00 FEET TO THE POINT OF BEGINNING, CONTAINING 23,897 SQUARE FEET OR 0.549 ACRES, MORE OR LESS.

Section 2. Said right-of-way us further described and shown hachured on the attached Right-of-Way Vacation, marked "Exhibit A" and incorporated herein by this reference thereto.

Section 3. The City Clerk is hereby directed to have this ordinance recorded in the office of the Recorder of Deeds of St. Louis County, Missouri.

Section 4. This ordinance shall take effect and be in force from and after its passage as provided by law.

PASSED and ADOPTED this 27<sup>th</sup> day of September, 2022.

  
MAYOR

ATTEST:

  
CITY CLERK

CERTIFIED TO BE CORRECT AS TO FORM:

  
CITY ATTORNEY

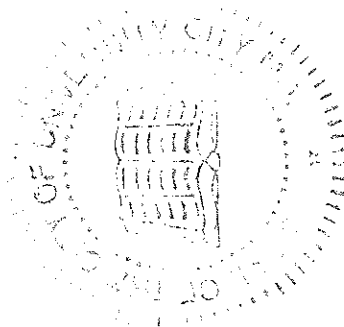

**"EXHIBIT A"**

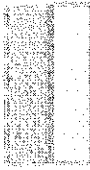
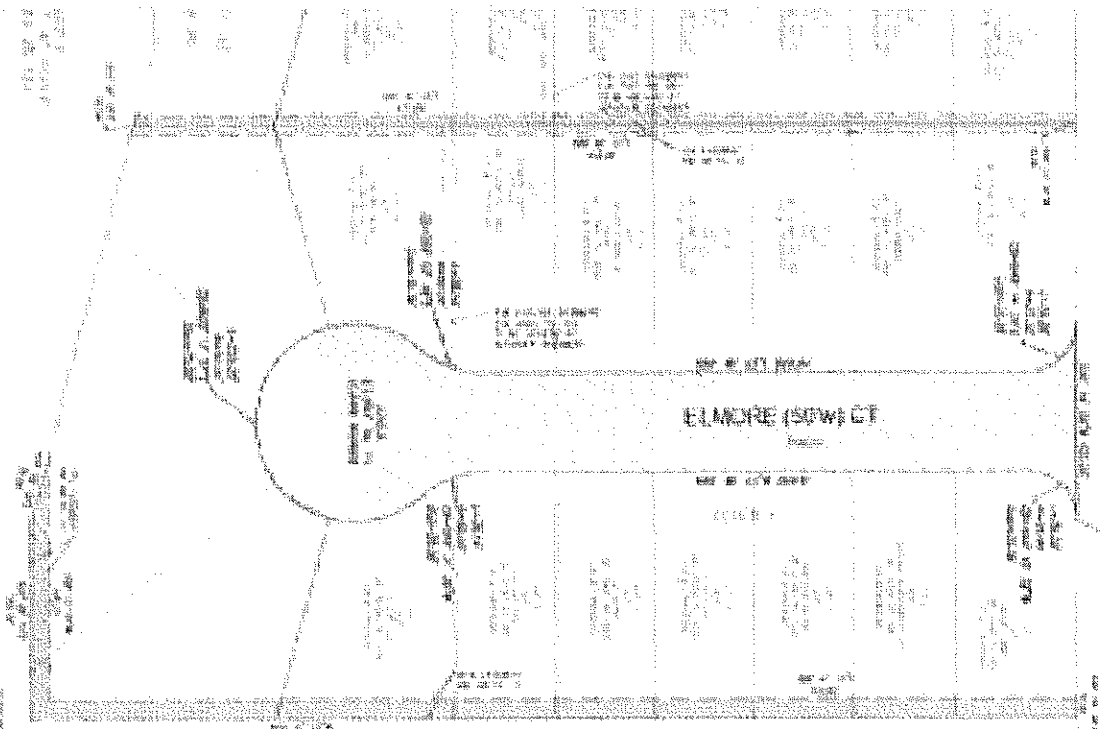

Scale: 1" = 100'

THIS PLAN IS THE PROPERTY OF THE ARCHITECT AND IS NOT TO BE REPRODUCED OR COPIED IN ANY MANNER WITHOUT HIS WRITTEN CONSENT. THE ARCHITECT ASSUMES NO LIABILITY FOR THE ACCURACY OF THE INFORMATION PROVIDED HEREON. THE ARCHITECT'S RESPONSIBILITY IS LIMITED TO THE DESIGN AND CONSTRUCTION OF THE PROJECT AS SHOWN ON THIS PLAN. THE ARCHITECT DOES NOT WARRANT THE ACCURACY OF THE INFORMATION PROVIDED HEREON. THE ARCHITECT'S RESPONSIBILITY IS LIMITED TO THE DESIGN AND CONSTRUCTION OF THE PROJECT AS SHOWN ON THIS PLAN. THE ARCHITECT DOES NOT WARRANT THE ACCURACY OF THE INFORMATION PROVIDED HEREON.

ST. PATRICK COURTS VACATION  
 CHICAGO, ILLINOIS  
 ARCHITECT: [Name]  
 ENGINEER: [Name]

NO. 1	ST. PATRICK COURTS VACATION
NO. 2	CHICAGO, ILLINOIS
NO. 3	ARCHITECT: [Name]
NO. 4	ENGINEER: [Name]
NO. 5	DATE: [Date]



**ST. PATRICK COURTS VACATION**

CHICAGO, ILLINOIS  
 ARCHITECT: [Name]  
 ENGINEER: [Name]